

MASOMO PORTAL STUDENT MANUAL

Login to masomo portal

- ❖ Open a web browser and navigate to <https://masomo.mut.ac.ke>

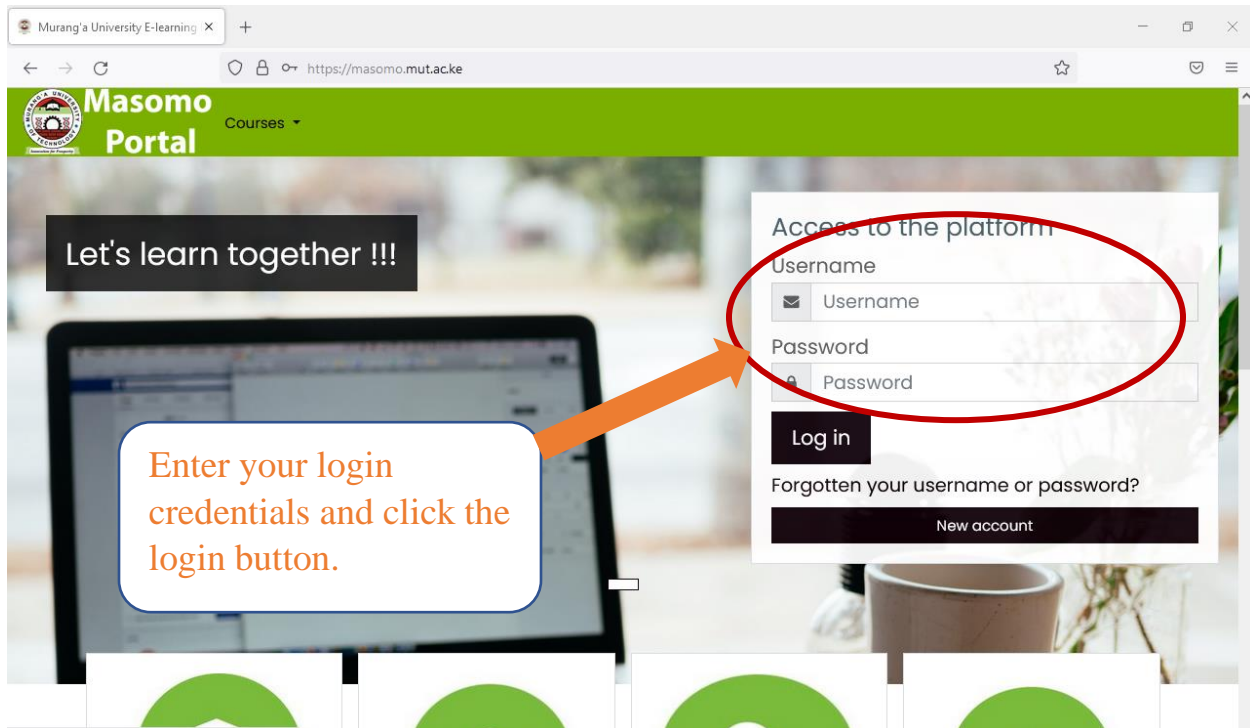

TO LOGIN

The students will use their **registration numbers** as the username and also as **password** but the password is in CAPS.

Example: **Username:** sc401/5213/2018

Password: SC401/5213/2018

Synchronizing the Registered Units

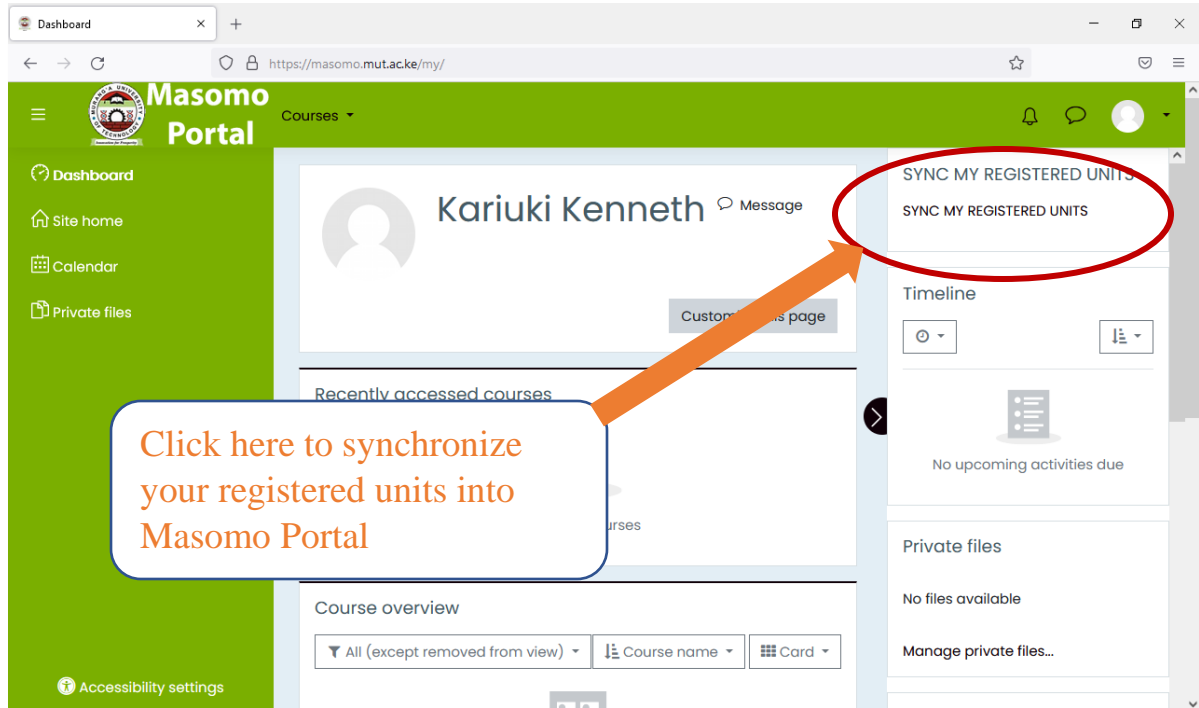

Once you login click on **SYNC MY REGISTERED UNITS** to enroll your registered units on masomo portal.

NOTE: *(Student ought to have registered the units on student portal before visiting masomo portal).*

Once you click SYN MY REGISTERED UNITS, you will see my courses button on the left side of the dashboard.

Dashboard

https://masomo.mut.ac.ke/my/

Masomo Portal

Courses ▾

Dashboard

Site home

Calendar

Private files

My courses

SCS705

SIT702

Accessibility settings

Kariuki Kenneth Message

Customise this page

SYNC MY REGISTERED UNITS

SYNC MY REGISTERED UNITS

Timeline

Recently accessed courses

No re

Course overview

All (except removed from view) ▾ Course name ▾ Card ▾

Manage private files...

Click My Courses button to see your enrolled units.
Click on the unit to access the posted learning materials

You can access of learning materials posted by your lecturer by clicking on the unit.